

# CLEANROOM EXIT SURFACE SERIES

PROJECT: \_\_\_\_\_  
 TYPE: \_\_\_\_\_  
 PRODUCT: \_\_\_\_\_  
 APPROVED BY: \_\_\_\_\_

## PRODUCT FEATURES

- Intended for Cleanrooms, Hospitals, Hi-Tech Manufacturing, Laboratories, Food Processing Facilities, Commercial Kitchens, and more
- Ceiling or wall surface mount installation
- Red or green legend, optional single or double face
- Fixture is certified to UL standards by Intertek Testing Laboratory, UL924 Listed, and meets or exceeds NFPA 101 Life Safety Code. IP65 rated per IEC60598. ISO Class 4 (Fed Std. 209E/ Class 10)
- This product is Made in America and complies with the Buy American Act (BAA), and the Build America, Buy America Act (BABAA)



ESCS Series



## ORDERING INFORMATION

Example: ESCS-HC/IC-SF-LED-UN-RW

ESC		S		/			
<b>Series</b>	<b>Mounting</b> S = Surface	<b>Housing</b> HC = 20Ga. CRS Painted HS = 20Ga. SS Brushed	<b>Inset Frame</b> IC = 20Ga. CRS Painted IB = 20Ga. SS Brushed	<b>Face</b> SF = Single Face DF = Double Face	<b>Lamp Type</b> LED = LED Module		
<b>Voltage</b> 12 = 120V 27 = 277V UN = Universal (120V-277V)		<b>Lettering</b> RW = Red Letters GW = Green Letters		<b>Options</b> EM = Emergency Battery* TH = Tamper-resistant Torx® fasteners with center pin reject  *If stored, batteries should be fully recharged every six months and kept between 0°C-25°C to maintain optimal battery capacity.			



**New Star Lighting**

2225 W Pershing Rd, Chicago, IL 60609  
 (773) 847-1400  
 www.newstarlighting.com

Specifications and dimensions are subject to change without notice. For additional options and dimensional details, please consult your New Star Lighting representative.

© 2026, New Star Lighting. All rights reserved. Unauthorized duplication or distribution is prohibited.

## SPECIFICATIONS

**CONSTRUCTION:** 20-Gauge formed cold rolled steel or brushed stainless steel housing with continuous seam welds.

**FRAME:** Inset doorframe in 20-gauge cold rolled steel or 20-gauge brushed stainless steel.

**LENS:** .125 clear polycarbonate lens.

**ELECTRICAL:** Long life LED system illuminates Red or Green legend. Optional single face or double face. 7W.

**FASTENERS:** Stainless steel Phillips flathead fasteners with captive cage nuts. Finish to match doorframe.

**LEGENDS:** Legend illuminated by internal high output LEDs. Lettering 6" high with .750" stroke. Polycarbonate red or green letters against white translucent background panel. Field selectable chevron inserts.

**FINISH:** White antimicrobial polyester powder coat finish following multi-stage iron phosphate pre-treatment. Stainless steel housing and overlapping frame will be left unpainted if specified.

**GASKET:** Closed cell EPDM and closed cell silicone gaskets prevent air contaminants from entering the fixture.

**INSTALLATION:** Ceiling or wall surface mount installation.

**WARRANTY:** Limited five (5) year warranty.

**LABEL:** Fixture is certified to UL standards by Intertek Testing Laboratory, UL924 Listed, and meets or exceeds NFPA 101 Life Safety Code. IP65 rated per IEC60598. ISO Class 4 (Fed Std. 209E/ Class 10), UL924. This product is Made in America and complies with the Buy American Act (BAA), and the Build America, Buy American Act (BABAA).

## DIMENSIONAL DATA

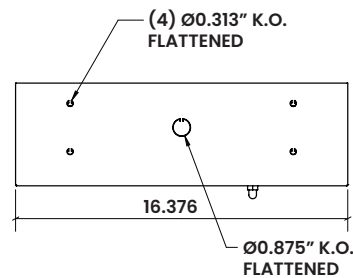
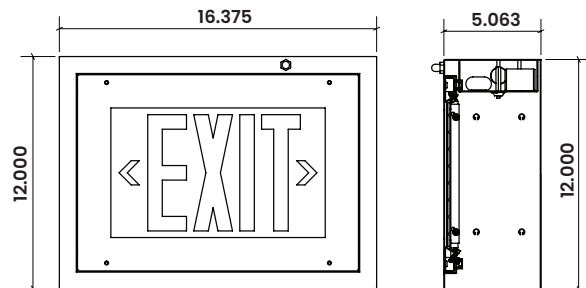
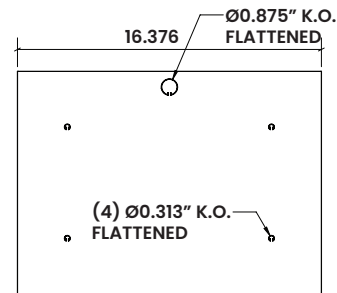

## DOUBLE FACE

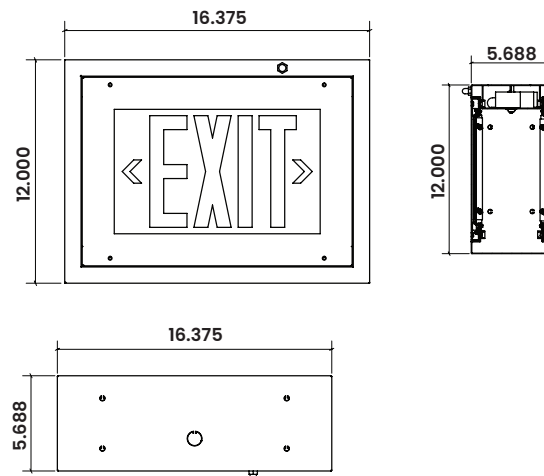

**New Star Lighting**

2225 W Pershing Rd, Chicago, IL 60609  
(773) 847-1400  
www.newstarlighting.com

Specifications and dimensions are subject to change without notice. For additional options and dimensional details, please consult your New Star Lighting representative.

© 2026, New Star Lighting. All rights reserved. Unauthorized duplication or distribution is prohibited.