

PROJECT: \_\_\_\_\_  
 TYPE: \_\_\_\_\_  
 PRODUCT: \_\_\_\_\_  
 APPROVED BY: \_\_\_\_\_

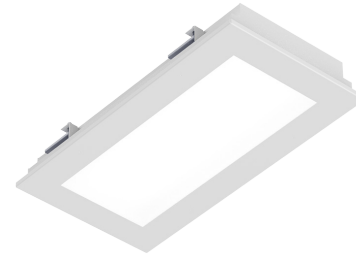

## PRODUCT FEATURES

- Ligature-resistant features to support Behavioral Health applications
- Die formed, seam welded, and ground smooth cold rolled steel or stainless steel housing
- Tamper-resistant Torx® fasteners with center pin reject
- Fixture is IK10 listed per IEC60068-2-75
- This product is Made in America and complies with the Buy American Act (BAA), and the Build America, Buy America Act (BABAA)
- The DuraCare™ 37M is covered by the New Star Promise



37M Series

## ORDERING INFORMATION

Example: 37M12-F/C-L235-1C-0/A-90C-UN-DMI-WL



37M		DC	/					
Series	Size* 12 = 1 x 2 14 = 1 x 4 22 = 2 x 2 24 = 2 x 4  *Nominal Size, Dimensional Data on Page 2.	DC = DuraCare™	Housing A = 12Ga. CRS Painted B = 14Ga. CRS Painted C = 16Ga. CRS Painted D = 18Ga. CRS Painted E = 14Ga. SS Brushed F = 16Ga. SS Brushed G = 18Ga. SS Brushed H = 14Ga. SS Painted J = 16Ga. SS Painted K = 18Ga. SS Painted	Frame A = 12Ga. CRS Painted B = 14Ga. CRS Painted C = 16Ga. CRS Painted E = 14Ga. SS Brushed F = 16Ga. SS Brushed H = 14Ga. SS Painted J = 16Ga. SS Painted	Lumen Output* 37M12-14: L2 = Low L3 = High 37M22-24: L2 = Low L4 = Standard L6 = Medium L8 = High  *Subject to change. Performance Data on Page 3.	Color Temp. 35 = 3500K 40 = 4000K 50 = 5000K  TW1 = Tunable White 2700K to 5000K**** TW2 = Tunable White 27000 to 6500K****  *See Page 2 to specify system. *Choosing this, you must also pick a BIOS driver under the Driver column. ***Please choose corresponding BIOS driver. ****Select Tunable White Driver in Driver Options	BIOS Options:** BIOS Color Temp.*** B30 = 3000K B35 = 3500K B40 = 4000K  BIOS Tunable CCT*** BTW1 = 2700K-3500K BTW2 = 2700K-4000K	Circuits 1C = 1 Circuit 2C = 2 Circuit
/			90C					
Outer Lens 0 = No Lens 1 = .187 Clear Poly. 2 = .250 Clear Poly. 3 = .375 Clear Poly. 5 = .187 Clear Temp. Glass 6 = .250 Clear Temp. Glass 7 = .375 Clear Temp. Glass*  *Must use with 12Ga. or 14Ga. Frame		Inner Lens A = .125 Prismatic Acrylic* B = .125 Prismatic Poly.* C = .156 Prismatic Poly.* D = .187 Prismatic Poly.* F = .156 Prismatic Acrylic G = .140 DR Acrylic** H = .125 White Frost Poly. LC3 = .125 White Frosted Poly.  *Not recommended for BIOS. **N/A with WL option.		CRI 90C = 90 CRI	Voltage 12 = 120V 27 = 277V 34 = 347V UN = Universal (120V-277V)	Driver DM = 0-10V dimming with 10-100% range DMI = 0-10V dimming with 1-100% range SD2 = Step Dim. Driver (50-100%)* SD3 = Step Dim. Driver (25-50-100%)* STC = Static BIOS Driver** DMB = Dynamic BIOS Dimming Driver***  Tunable White Driver****: DALI8 = 1-Channel Dali8 TWD = 2-Channel 0-10V  * N/A with 277V. **Driver only works with BIOS LEDs. 0-10V with Dimming from 1%-100% ***Driver only works with BIOS LEDs. 0-10V Intensity Dimming to 1% and Dim-to-Dark capabilities. ****Tunable White Driver requires choice of TW1 or TW2 in Color Temp column	Options FZ1 = Fuse (120V) FZ2 = Fuse (277V) EL1 = Emerg. Bat. LED Low (1100-1250 lm)* EL2 = Emerg. Bat. LED High (1900-2000 lm)** LN = LED Night Light*** AH = Allen Head Screws with Center Pin Reject WL = Wet Location (Use under covered ceiling) PF = Plaster Frame & Yoke  *If stored, batteries should be fully recharged every six months and kept between 0°C-25°C to maintain optimal battery capacity. **N/A for 37M12. If stored, batteries should be fully recharged every six months and kept between 0°C-25°C to maintain optimal battery capacity. ***3500K Night Light with integrated switch allows light levels at 100%, 70%,40% and 10%. **** N/A with 277V.	

## SPECIFICATIONS

**HOUSING:** Die formed, seam welded, and ground smooth cold rolled steel or stainless steel housing. Incorporates a removable reflector unitized with all electrical components for easy installation and maintenance.

**FRAME:** Die formed one-piece frame with tightly closed corners (material and gauge to match housing).

**HINGE:** 16-Gauge drop hinge with welded ends to prevent removal (material to match housing).

**LENS:** Outer and inner lens options secured with "Z" retainers with welded studs six inches apart for maximum strength.

**LED:** Available in three color temperatures 3500K, 4000K, and 5000K with maximum 3-step MacAdam variation allowance. Other color temperatures available, consult factory. Minimum 80 CRI standard.

Optional BIOS® SkyBlue® circadian solutions to produce the healthy "blue sky" light signal with blue spectrum peak at 490nm+ for circadian entrainment. Bio-Dimming™ reduces CCT by 2700K.

**ELECTRICAL:** 0-10V dimming available with 10-100% range and 1-100% range. Must specify dimming under options.

### OPTIONAL DRIVER OPTIONS:

#### BIOS DRIVER OPTIONS:

**STC** – BIOS control 0-10V with Dimming from 1%-100% and Dynamic Bios Dimming with 0-10V Intensity Dimming to 1% and Dim-to-Dark capabilities.

**DMB** – Dynamic BIOS control 0-10V with dynamic spectrum and BIOS SkyBlue® with Bio-Dimming™, which changes a spectral qualities by removing the SkyBlue component when dimming from 100%-51%, while light output remains relatively constant; CCT will decrease approximately 500K through bio-dimming; dimming from 50% to 1% will then reduce light output.

#### TUNABLE WHITE DRIVER OPTIONS:

**DALI8** – DALI Type 8 (One DALI Address)

**TWD** – Two channel 0-10V dimming: one channel for brightness, one channel for CCT

**FASTENERS:** Tamper-resistant Torx® head fasteners with center pin reject.

**FINISH:** White antimicrobial polyester powder coat finish following multi-stage iron phosphate pre-treatment unless stainless steel brushed is specified. Antimicrobial finish available under options.

**GASKET:** Black neoprene gasket around door frame to prevent light leaks.

**INSTALLATION:** Easy Flange installation with adjustable 90° swing arm system. Hardware by others.

**WARRANTY:** Five (5) year warranty.

**LABEL:** Fixture is certified to UL standards by Intertek Testing Laboratory. Fixture is IK10 listed per IEC60068-2-75.

## DIMENSIONAL DATA

### 37M12

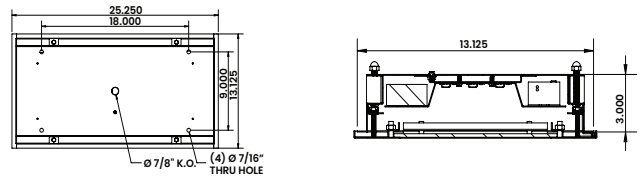

### 37M14

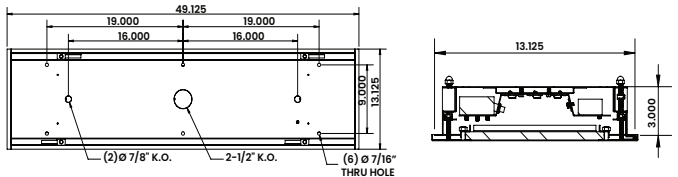

### 37M22

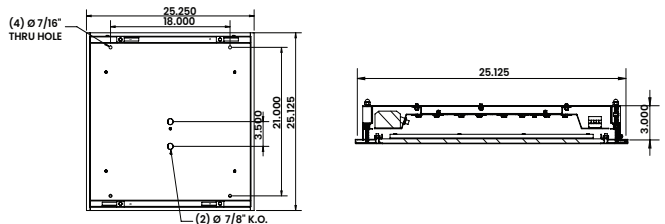

### 37M24

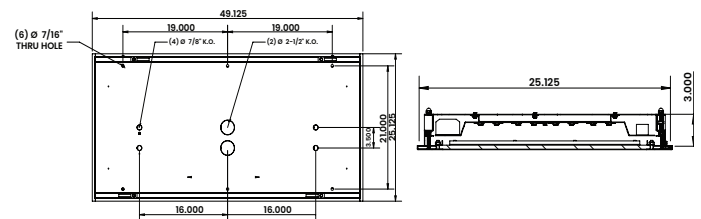

The DuraCare™ 37M LED Series is covered by our New Star Promise.

Our promise means we will repair or replace any of our High Abuse or Vandal-Resistant architectural luminaires when installed according to our instructions for the life of the original installation if the fixture should fail due to physical abuse\*.

\*Damage caused by gunfire and chemical reactions is not covered by the New Star Promise.



**New Star Lighting**

2225 W Pershing Rd, Chicago, IL 60609  
(773) 847-1400  
www.newstarlighting.com

Specifications and dimensions are subject to change without notice. For additional options and dimensional details, please consult your New Star Lighting representative.

© 2025, New Star Lighting. All rights reserved. Unauthorized duplication or distribution is prohibited.

## PERFORMANCE DATA

\*LEDs are frequently updated therefore values may change without notice.

MODEL	OUTPUT	COLOR TEMP.	LUMENS DELIVERED	EFFICACY (lm/W)	INPUT POWER (W)
37M12	L2 = Low	4000K	2750	110	25
	L3 = High	4000K	4125	110	37.5
37M14	L2 = Low	4000K	5500	110	50
	L3 = High	4000K	8250	110	75
37M22	L2 = Low	4000K	2750	110	25
	L4 = Standard	4000K	5500	110	50
	L6 = Medium	4000K	8250	110	75
	L8 = High	4000K	11000	110	100
37M24	L2 = Low	4000K	5500	110	50
	L4 = Standard	4000K	11000	110	100
	L6 = Medium	4000K	16500	110	150
	L8 = High	4000K	22000	110	200

## THIS ONLY PERTAINS TO BIOS PERFORMANCE DATA\*

\*Data is with 80 CRI chip. LEDs are frequently updated therefore values may change without notice.

MODEL	OUTPUT	COLOR TEMP.	LUMENS DELIVERED	EFFICACY (lm/W)	INPUT POWER (W)
 <b>37M12</b>	L2 = Low	4000K	2475	91	27
	L3 = High	4000K	3640	91	40
 <b>37M14</b>	L2 = Low	4000K	4823	91	53
	L3 = High	4000K	7280	91	80
 <b>37M22</b>	L2 = Low	4000K	2457	91	27
	L4 = Standard	4000K	4823	91	53
	L6 = Medium	4000K	7280	91	80
	L8 = High	4000K	9646	91	106
 <b>37M24</b>	L2 = Low	4000K	4823	91	53
	L4 = Standard	4000K	9646	91	106
	L6 = Medium	4000K	14560	91	160
	L8 = High	4000K	19292	91	212