

PROJECT: \_\_\_\_\_  
 TYPE: \_\_\_\_\_  
 PRODUCT: \_\_\_\_\_  
 APPROVED BY: \_\_\_\_\_

## PRODUCT FEATURES

- Intended for Fall Prevention in healthcare settings, including Patient Rooms, Patient Bathrooms, Corridors, Lobbies, Waiting Rooms, Nurses' Stations, and more
- Faceplate constructed of durable cast zinc-magnesium and features integral embedded driver (5W max.)
- 3 Face plates styles: horizontal louver, horizontal hood and open frame with diffuse lens
- Available in 3000K White, Amber & Blue LED
- Certified to UL standards by Intertek Testing Laboratories for Wet Location. IP65 certified per IEC60598



SNL Series

## ORDERING INFORMATION

Example: SNL3-OF-L30-80C-12-W



SNL3		L		80C
<b>Series</b>	<b>Faceplate</b> OF = Open HL = Horizontal Louver HH = Horizontal Hood	<b>Source</b> L = LED	<b>Color Temp.</b> 30 = 3000K A = Amber B = Blue	<b>CRI</b> 80C = 80 CRI

<b>Voltage</b> 12 = 120V 27 = 277V	<b>Finish</b> W = White DB = Dark Bronze BN = Brushed Nickel	<b>Options</b> HB = Hanger Bars TH = Tamper-resistant Torx® head fasteners
--	---	--



**New Star Lighting**

2225 W Pershing Rd, Chicago, IL 60609  
 (773) 847-1400  
 www.newstarlighting.com

Specifications and dimensions are subject to change without notice. For additional options and dimensional details, please consult your New Star Lighting representative.

© 2026, New Star Lighting. All rights reserved. Unauthorized duplication or distribution is prohibited.

## SPECIFICATIONS

**FACEPLATE:** Durable cast zinc-magnesium in three styles: horizontal hood, open frame with diffused opal lens, or horizontal louver.

**LENS:** .125" White acrylic lens.

**LED:** Available in 3000K, Amber or Blue LED with maximum 3-step MacAdam variation allowance. Other color temperatures available, consult factory. Minimum 50,000 hours with 70% lumen maintenance in a 25°C ambient temperature environment, compliant with IES LM-80 testing standards.

**ELECTRICAL:** 120VAC or 277VAC 50/60HZ integrated, embedded Driver Max @ 5 watt 3.6 watt normal.

**FINISH:** White or Dark Bronze antimicrobial polyester powder coat finish following multi-stage iron phosphate pretreatment on all exposed room-side painting surfaces, unless otherwise specified. Brushed Nickel is also available.

**INSTALLATION:** Recessed with Integral backbox.

**WARRANTY:** 5 Year Warranty.

**LABEL:** Certified to UL standards by Intertek Testing Laboratories for, IP65 certified per IEC60598.

## DIMENSIONAL DATA

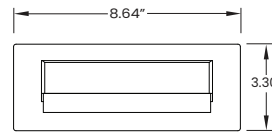

HORIZONTAL HOOD

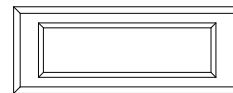
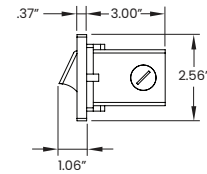

OPEN FRAME WITH  
DIFFUSED OPAL LENS



OPEN FRAME WITH  
DIFFUSED OPAL LENS

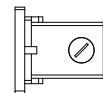

HORIZONTAL LOUVER

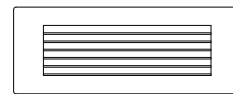

HORIZONTAL LOUVER

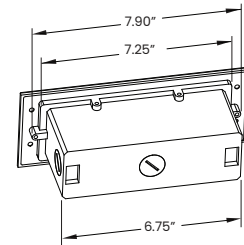

**New Star Lighting**

2225 W Pershing Rd, Chicago, IL 60609  
(773) 847-1400  
www.newstarlighting.com

Specifications and dimensions are subject to change without notice. For additional options and dimensional details, please consult your New Star Lighting representative.

© 2026, New Star Lighting. All rights reserved. Unauthorized duplication or distribution is prohibited.