

HIGH ABUSE DOWNLIGHT SERIES



PROJECT: _____
 TYPE: _____
 PRODUCT: _____
 APPROVED BY: _____

PRODUCT FEATURES

- Intended for vandal-prone applications including Public Areas, Schools, Locker Rooms, Corridors, Commercial Settings, and more
- 4" and 6" sealed recessed downlight, round or square aperture options
- Suitable for non-IC and wet location installations, IK10 listed per IEC60068-2-75: 2014, and IP65 rated per IEC60598
- Variety of wattages and lumen packages, up to 3750lm at 43W (6")
- This product is Made in America and complies with Buy American Act (BAA)
- The HADL Series is covered by the New Star Promise

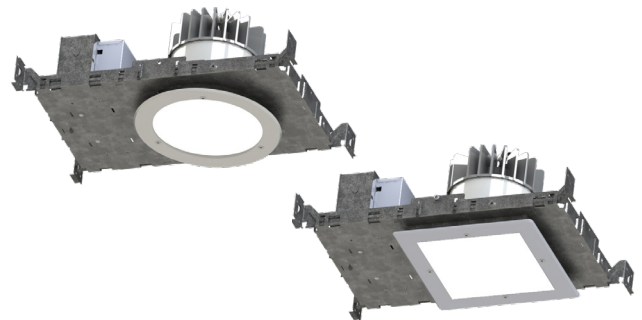

HADL SERIES



ORDERING INFORMATION

Example: HADL4R-LW50-F-A-1-90C-UN-DMI

HADL						F	
Series	Aperture 4 = 4 inch 6 = 6 inch	Shape R = Round S = Square	Lumen Output* LW = Low SD = Standard MD = Medium HG = High *Specify desired lumens. Subject to change. **Higher lumen packages for 6" only. Subject to change. Performance data on page 3.	Color Temp. 30 = 3000K 35 = 3500K 40 = 4000K 50 = 5000K RGBW = RGB + 4000K AMB = Amber (585-595nm) BLU = Blue (470nm) RGBW/30 = RGB + 3000K* RGBW/40 = RGB + 4000K** *Must use with DMX Driver	BIOS BIOS Color Temp. B35 = 3500K B40 = 4000K B50 = 5000K BIOS Tunable CCT BTW1 = 3500K-2700K BTW2 = 4000K-2700K Tunable White TW1 = 2700K to 5000K TW2 = 2700K to 6500K	Trim F = Flange	Trim Finish A = .080 Alum. Painted B = 18Ga. CRS Painted C = 18Ga. 304 Brushed* D = 18 Ga. SS Painted* *Additional fees may apply. Consult factory for details.
Flush Lens (Tamper Resistant lens) 1 = .125 Clear Polycarbonate 2 = .250" Clear Polycarbonate			CRI 80C = 80 CRI 90C = 90 CRI	Voltage 12 = 120V 27 = 277V 34 = 347V UN = Universal (120-277V)	Driver Type DMI = 0-10V Dimming with 1-100% range DMT = 0-10V & TRIAC/ELV RGBW Driver* DMX = DMX Driver *The DMX driver is compatible for RGBW options BIOS Driver** STC = Static BIOS*** DMB = Dynamic BIOS Dimming**** **BIOS driver requires choice of either static or tunable BIOS options in Color Temp section ***0-10V with Dimming from 1%-100% ****0-10V Intensity Dimming to 1% and Dim-to-Dark capabilities Tunable White Driver+ TWD = 2-Channel 0-10V DALI8 DALI8 = 1-Channel Dali8 +Tunable White Driver requires choice of TW1 or TW2 in Color Temp column. Does Not apply to BIOS		Options FZ1 = Fuse (120V) FZ2 = Fuse (277V) EM = Emerg. Battery (Remote)* W = Wing Bracket *If stored, batteries should be fully recharged every six months and kept between 0°C-25°C to maintain optimal battery capacity.



New Star Lighting

2225 W Pershing Rd, Chicago, IL 60609
 (773) 847-1400
www.newstarlighting.com

Specifications and dimensions are subject to change without notice. For additional options and dimensional details, please consult your New Star Lighting representative.

© 2025, New Star Lighting. All rights reserved. Unauthorized duplication or distribution is prohibited.

SPECIFICATIONS

HEAT SINK: Custom diecast aluminum heat sink design for maximum thermal dissipation.

FRAME-IN KIT: 20-gauge die-formed, galvanized steel. Vertically adjustable collar accommodates ceiling thicknesses up to 1.25", adjustable post-installation. telescopic hanger bars come as standard. can be installed in either direction (wing bracket can be ordered as option) for installation with wood and steel frame joists and T-grid ceiling systems spaced up to 24" on center. Quick-access junction box accessible post-installation from above and below ceiling. Includes (7) 1/2" knock-outs to allow straight conduit runs.

TRIM: IP-rated trim/Light engine incorporates the heat sink, LED module, optics and lower trim. Configurable with an IP64-rated Flush lens trim that is secured to the Frame-In kit with hidden torsion springs or an IP65 Flush lens trim secured with three (Round) or four (Square) tamper resistant (Torx®) captive fasteners. Closed-cell gasketing at ceiling flange. See Trim Ordering Information for available options.

OPTICAL: Round or Square aperture. Diffuse Acrylic upper lens. 1/8" clear impact-resistant acrylic or polycarbonate flush lens at ceiling trim. Continuous seal between lens and trim ring. Available with various reflector finishes. See Ordering Information for available options.

ELECTRICAL: LED source available in multiple CCT and CRI combinations with a maximum 3-step MacAdam variation allowance. See Trim Ordering Information for available options. 120-277VAC or 347VAC, 50/60Hz electrical input with serviceable constant current driver (<20% THD, >0.90 PF). Minimum 85% driver efficiency. Standard 0-10V dimming with 1-100% range and dim-to-dark capabilities; 0.2mA maximum source current. Optional eldoLED ECOdrive DALI-2/LEDcode2 driver with 1-100% range.

Optional BIOS® SkyBlue® circadian solutions to produce the healthy "blue sky" light signal with blue spectrum peak at 490nm + for circadian entrainment. Bio-Dimming™ reduces CCT by 2700K.

INSTALLATION: Recessed drywall and grid installation. Frame adjustable to ceiling thickness 0.5" to 1.25".

WARRANTY: New Star Promise.

LABEL: Fixture is certified to UL standards by Intertek Testing Laboratory for non-IC and wet location installations. IP65 Rating per IEC60598. Certified for NSF2 Splash Zone/ Non-Food Zones. This product is Made in America and complies with Buy American Act (BAA).

DIMENSIONAL DATA

6" DOWNLIGHT

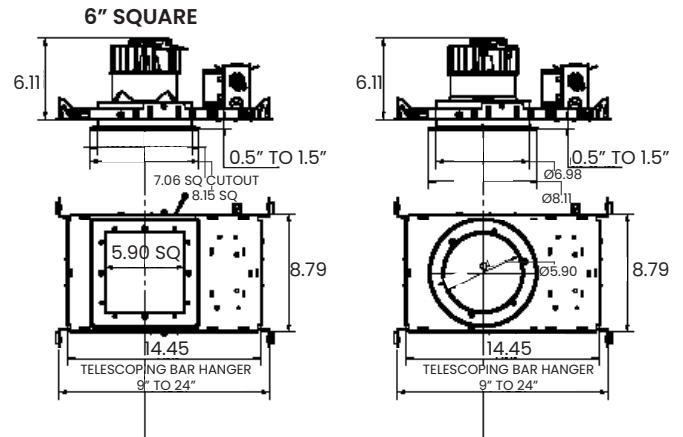

4" DOWNLIGHT

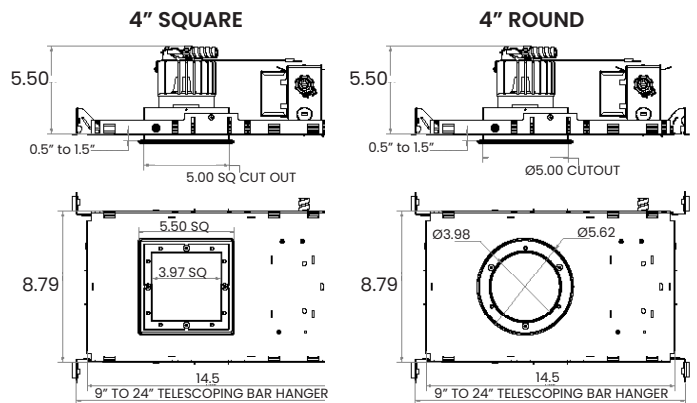

The High Abuse Downlight Series is covered by our New Star Promise.

Our promise means we will repair or replace any of our High Abuse or Vandal-Resistant architectural luminaires when installed according to our instructions for the life of the original installation if the fixture should fail due to physical abuse*.

*Damage caused by gunfire and chemical reactions is not covered by the New Star Promise.



New Star Lighting

2225 W Pershing Rd, Chicago, IL 60609
(773) 847-1400
www.newstarlighting.com

Specifications and dimensions are subject to change without notice. For additional options and dimensional details, please consult your New Star Lighting representative.

© 2025, New Star Lighting. All rights reserved. Unauthorized duplication or distribution is prohibited.

HIGH ABUSE DOWNLIGHT SERIES



PERFORMANCE DATA

6 IN Downlight Wide beam, 1500lm Engine, 115lm/W at 18.75W

SERIES	SHAPE	LUMENS OUTPUT	CCT	DELIVERED LUMENS	EFFICACY	SYSTEM WATTS
HADL6	S	LW= LOW	40K	1178	85.4	13.7
		STD= STANDARD	40K	1748	86.1	20.2
		MD= MEDIUM	40K	2296	84.7	27.1
		HG= HIGH	40K	3506	80.2	43.3

SERIES	SHAPE	LUMENS OUTPUT	CCT	DELIVERED LUMENS	EFFICACY	SYSTEM WATTS
HADL6	R	LW= LOW	40K	1270.8	92.1	13.8
		STD= STANDARD	40K	1886	92.9	20.3
		MD= MEDIUM	40K	2479	91.5	27.1
		HG= HIGH	40K	3750	85.8	43.7

SERIES	SHAPE	LUMENS OUTPUT	CCT	DELIVERED LUMENS	EFFICACY	SYSTEM WATTS
HADL4	S	LW= LOW	40K	1128	75	14
		STD= STANDARD	40K	1346	76	18
		MD= MEDIUM	40K	1515	76	21
		HG= HIGH	40K	1907	76	28

SERIES	SHAPE	LUMENS OUTPUT	CCT	DELIVERED LUMENS	EFFICACY	SYSTEM WATTS
HADL4	R	LW= LOW	40K	1087	73	14
		STD= STANDARD	40K	1375	74	18
		MD= MEDIUM	40K	1580	74	21
		HG= HIGH	40K	1935	69	28