

## IMPORTANT SAFE GUARDS:

- THIS PRODUCT MUST BE INSTALLED IN ACCORDANCE WITH THE APPLICABLE INSTALLATION CODE BY A PERSON FAMILIAR WITH THE CONSTRUCTION AND OPERATION OF THE PRODUCT AND THE HAZARDS INVOLVED.
- DISCONNECT POWER BEFORE BEGINNING INSTALLATION.
- FIXTURE MUST BE INSTALLED IN COMPLIANCE WITH THE NATIONAL ELECTRIC CODE AND ANY LOCAL CODES.
- TO BE INSTALLED ONLY BY A QUALIFIED ELECTRICIAN.
- PROPER GROUNDING IS REQUIRED TO INSURE PERSONAL SAFETY.
- READ ALL FIXTURE MARKINGS AND LABELS TO ENSURE CORRECT INSTALLATION OF FIXTURE.
- RISK OF FIRE, USE A MINIMUM OF 90C SUPPLY CONNECTORS.
- MAXIMUM MOUNTING HEIGHT OF 8FT. WHEN AN EMERGENCY PACK IS PROVIDED

## INSTALLATION INSTRUCTIONS:

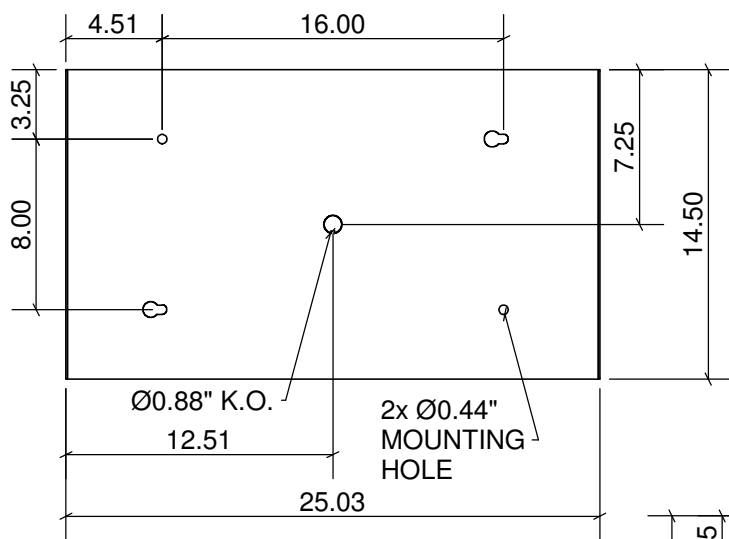

WARN2

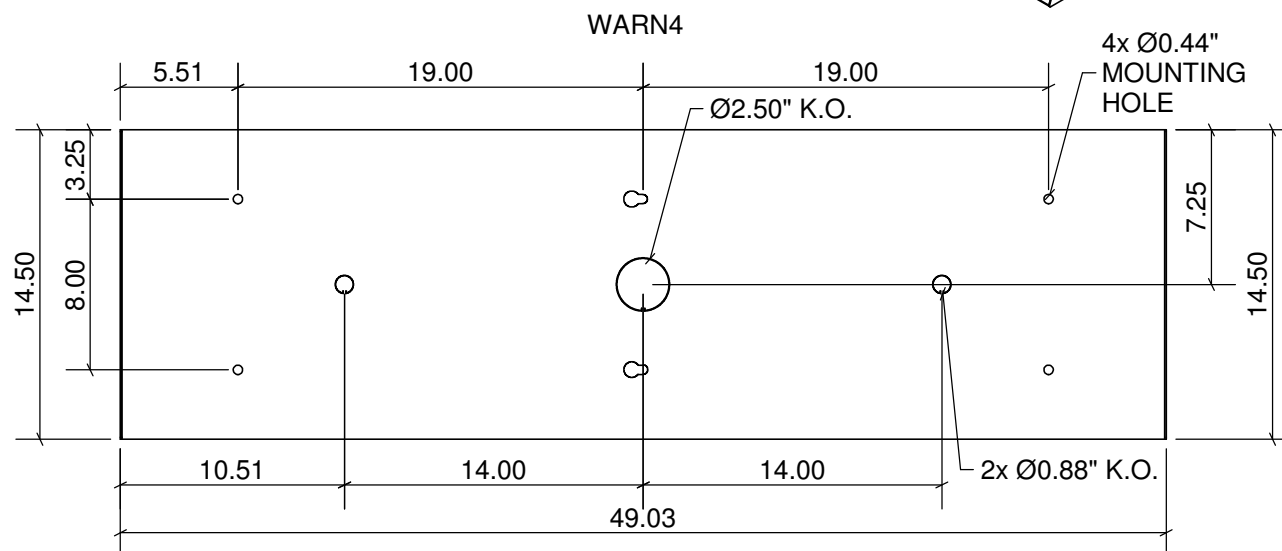
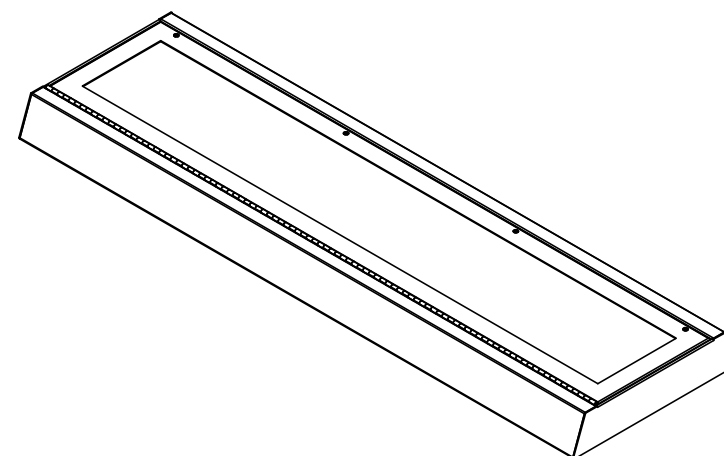

1. Open frame.

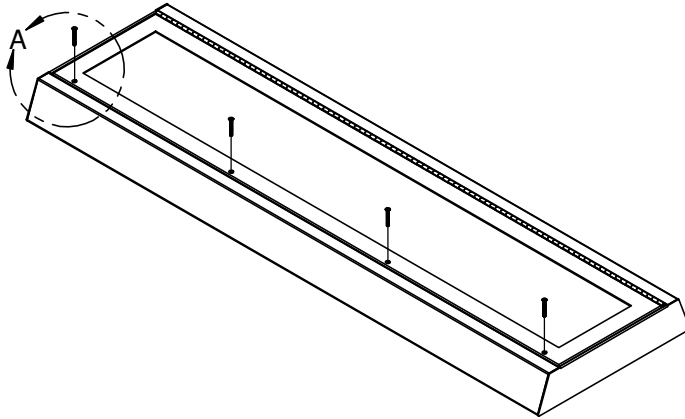

2. Remove LED gear tray.

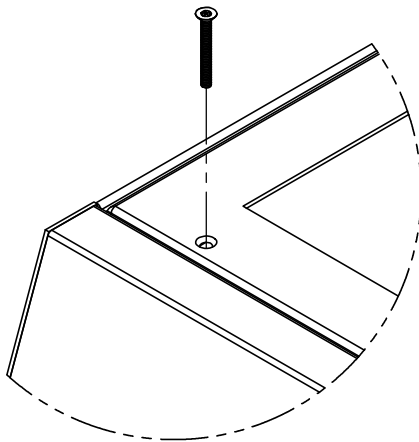
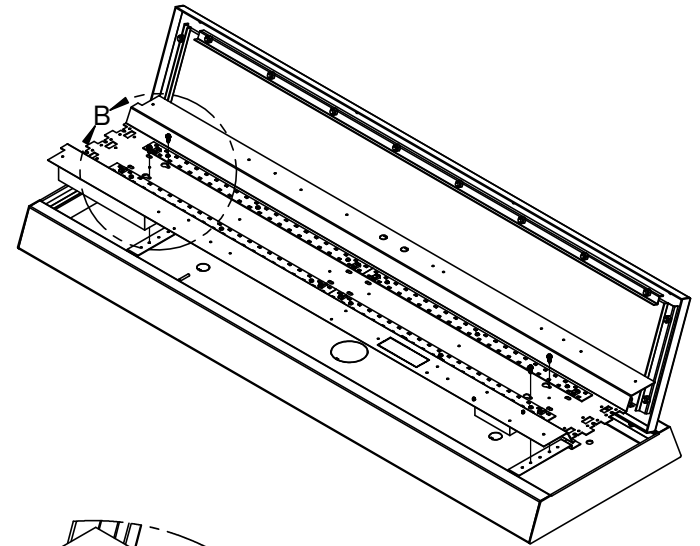

DETAIL A  
SCALE 1 : 3

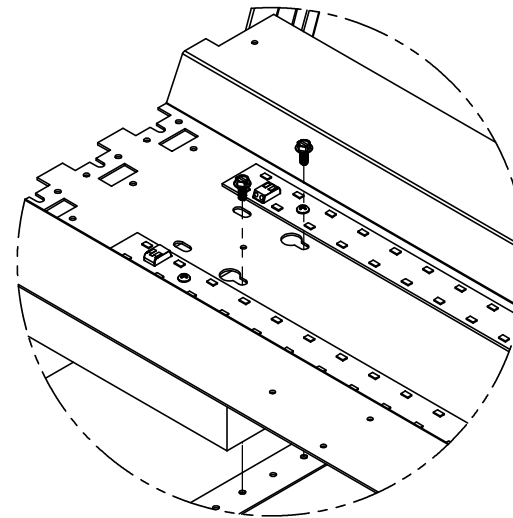

DETAIL B  
SCALE 1 : 4

3. Raise fixture to ceiling.

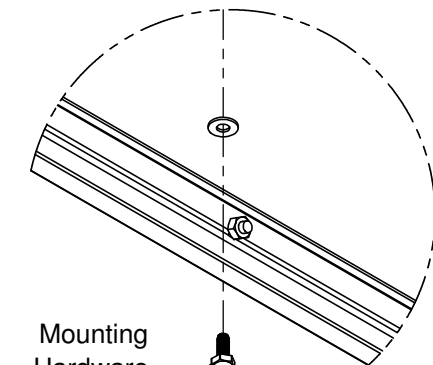
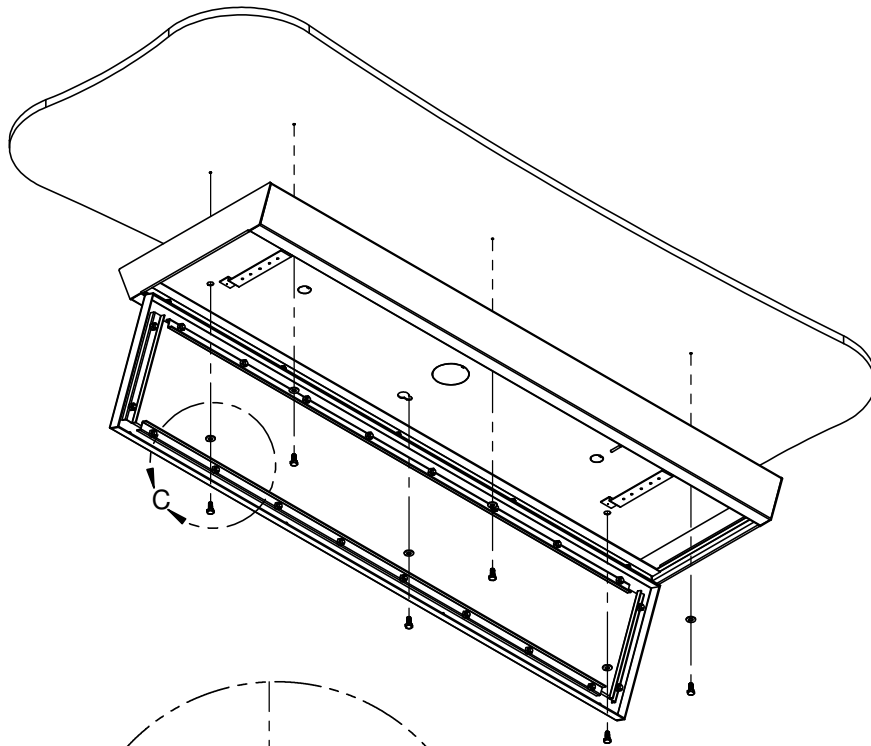

Mounting  
Hardware  
(By Others)

DETAIL C  
SCALE 1 : 4

4. After making necessary electrical connections  
attach LED gear tray and secure frame.

