

INSTALLATION INSTRUCTIONS

Fixture Family: AGF

Description: AGF SERIES - RECESSED INSTALLATION INSTRUCTIONS

IMPORTANT SAFETY INSTRUCTIONS

- This product must be installed in accordance with the applicable installation code by a person familiar with the construction and operation of the product and the hazards involved.
- Proper grounding is required to insure personal safety.
- Disconnect power before beginning installation.
- Read all fixture markings and labels to ensure correct installation of fixture.
- Fixture must be installed in compliance with the National Electric Code and any local codes.
- Risk of fire, use minimum of 90C supply connectors.
- To be installed only by a qualified electrician.
- These instructions may not cover all details or the variations. If additional information is needed, please contact New Star Lighting.

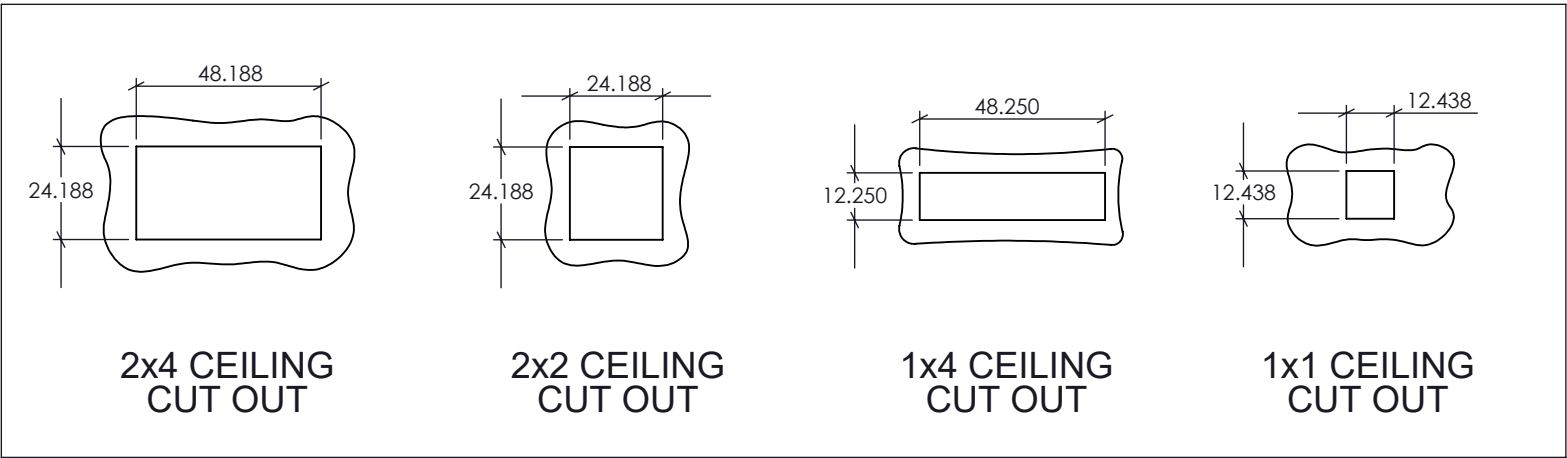

EXPLODED VIEW

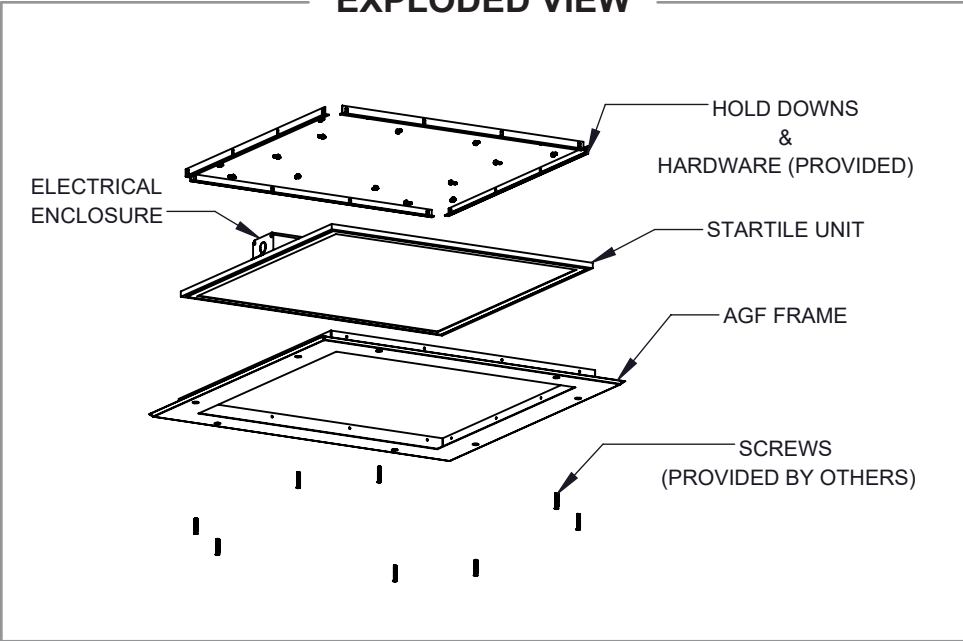

DIMENSION DATA

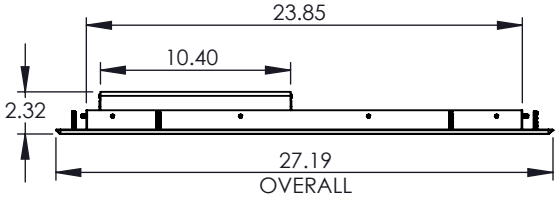

SIDE VIEW

Installer is responsible for adequately reinforcing walls and/or ceiling to support luminaire weight. These instructions do not claim to cover all details or variations in the equipment, procedure or process. Specifications and dimensions are subject to change.

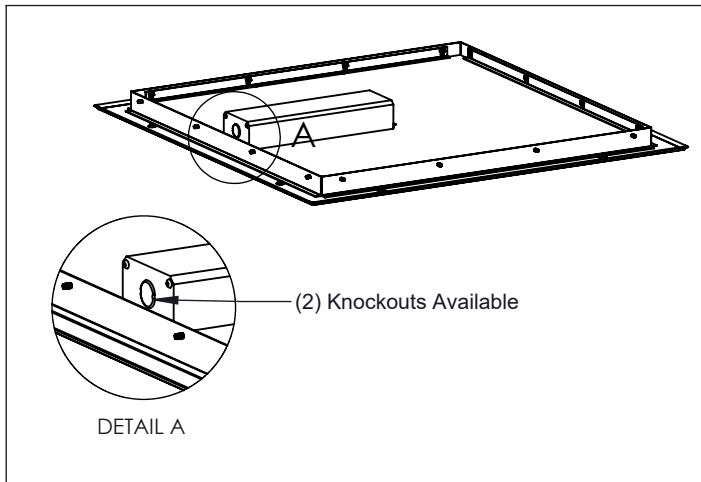

Figure 1

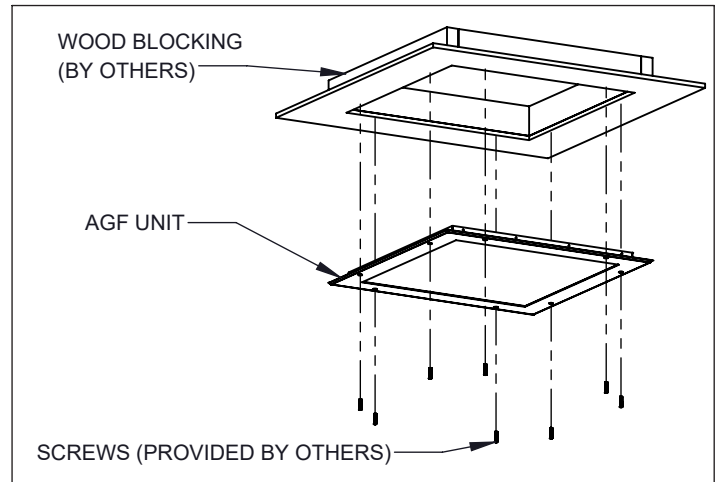

Figure 2

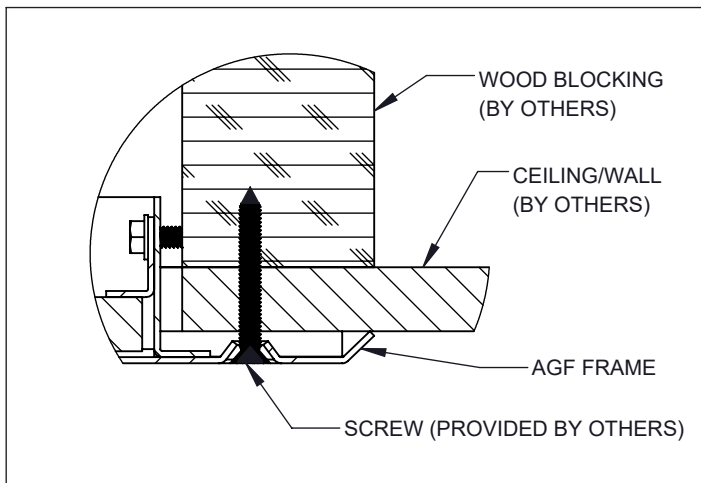

Figure 3

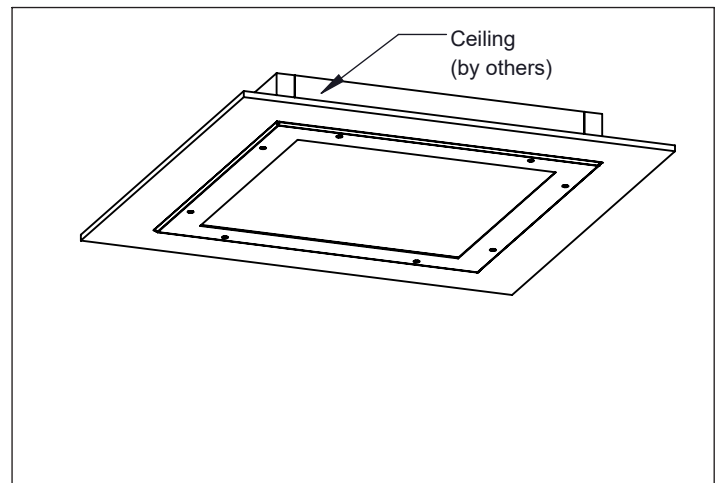

Figure 4

CEILING MOUNT

1. Make necessary electrical connections via K.O.s provided. (Fig. 1)
2. Ensure wood blocking is secured to structure before raising unit into ceiling/wall. (Fig. 2)
3. Screw AGF frame into wood blocking using holes provided. (Fig. 3)
4. AGF unit install completed. (Fig. 4)

Installer is responsible for adequately reinforcing walls and/or ceiling to support luminaire weight. These instructions do not claim to cover all details or variations in the equipment, procedure or process. Specifications and dimensions are subject to change.