

Fixture Family: AATBR

Description: Ceiling Mount Fixture

IMPORTANT SAFETY INSTRUCTIONS

- This product must be installed in accordance with the applicable installation code by a person familiar with the construction and operation of the product and the hazards involved.
 - Disconnect power before beginning installation.
 - Fixture must be installed in compliance with the National Electric Code and any local codes.
 - To be installed only by a qualified electrician.
- Proper grounding is required to insure personal safety.
 - Read all fixture markings and labels to ensure correct installation of fixture.
 - Risk of fire, use minimum of 90C supply connectors.
 - These instructions may not cover all details or the variations. If additional information is needed, please contact New Star Lighting.

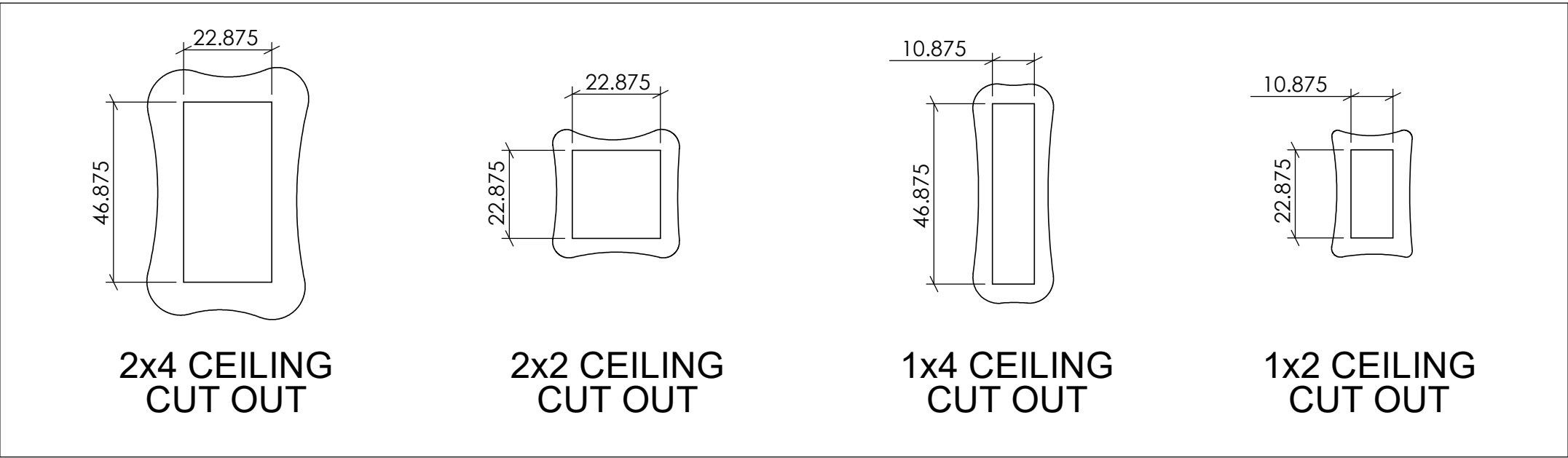

EXPLODED VIEW

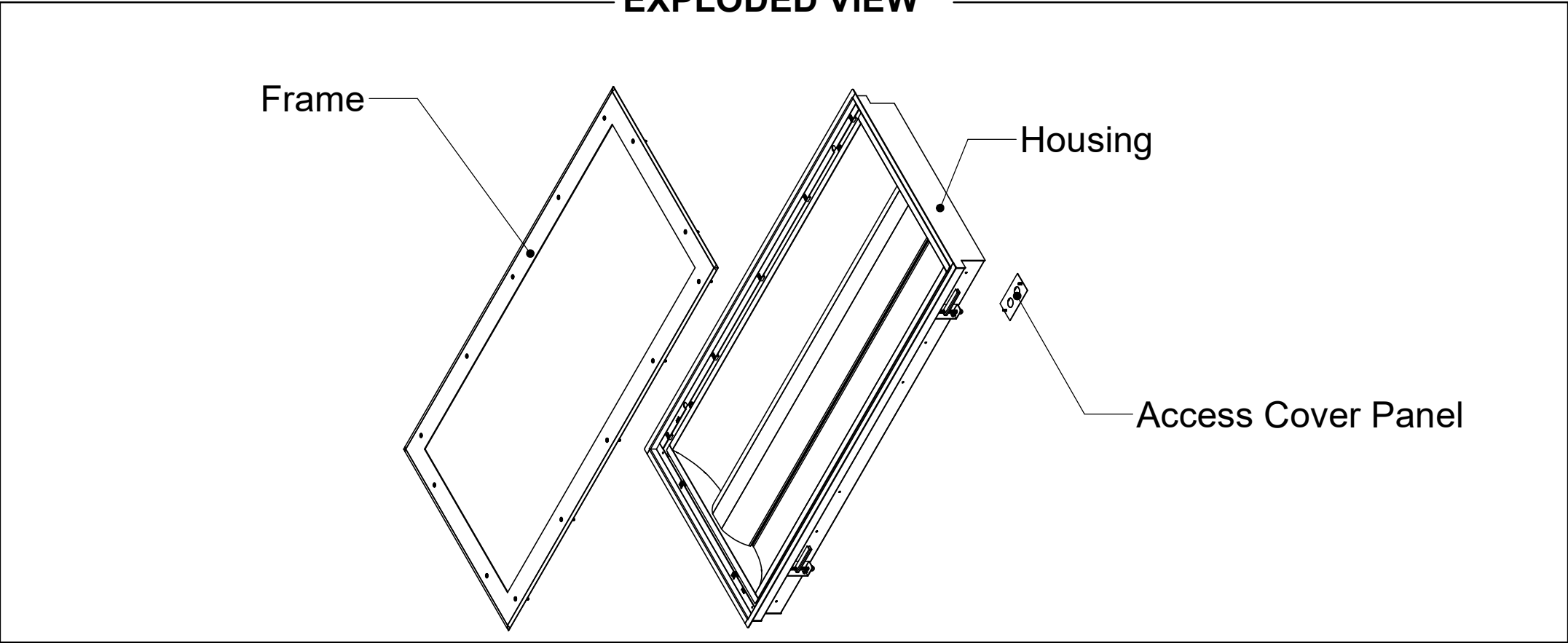

Installer is responsible for adequately reinforcing walls and/or ceiling to support luminaire weight. These instructions do not claim to cover all details or variations in the equipment, procedure or process. Specifications and dimensions are subject to change.

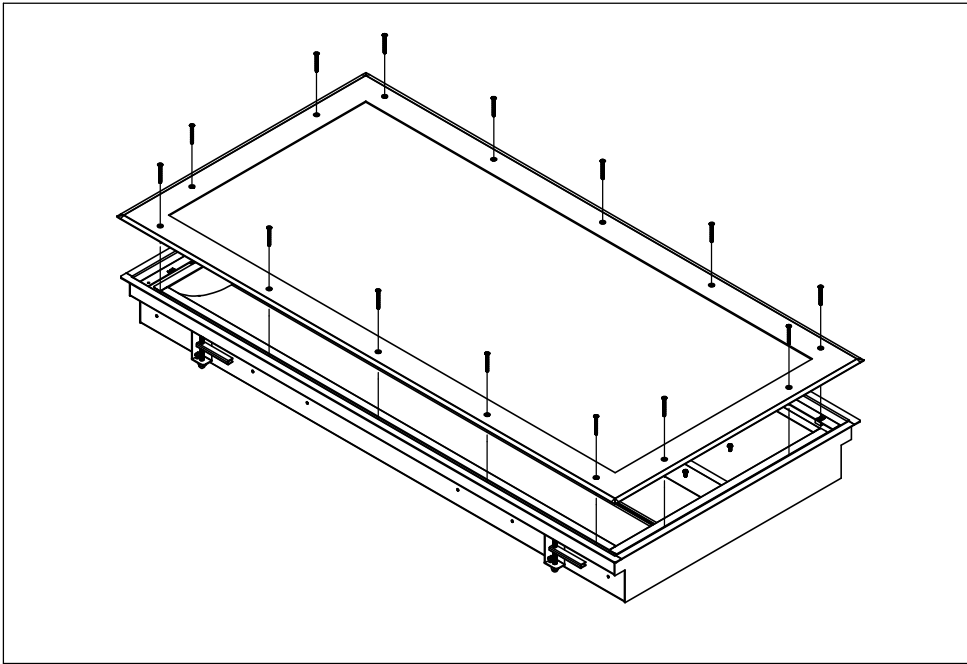

Figure 1

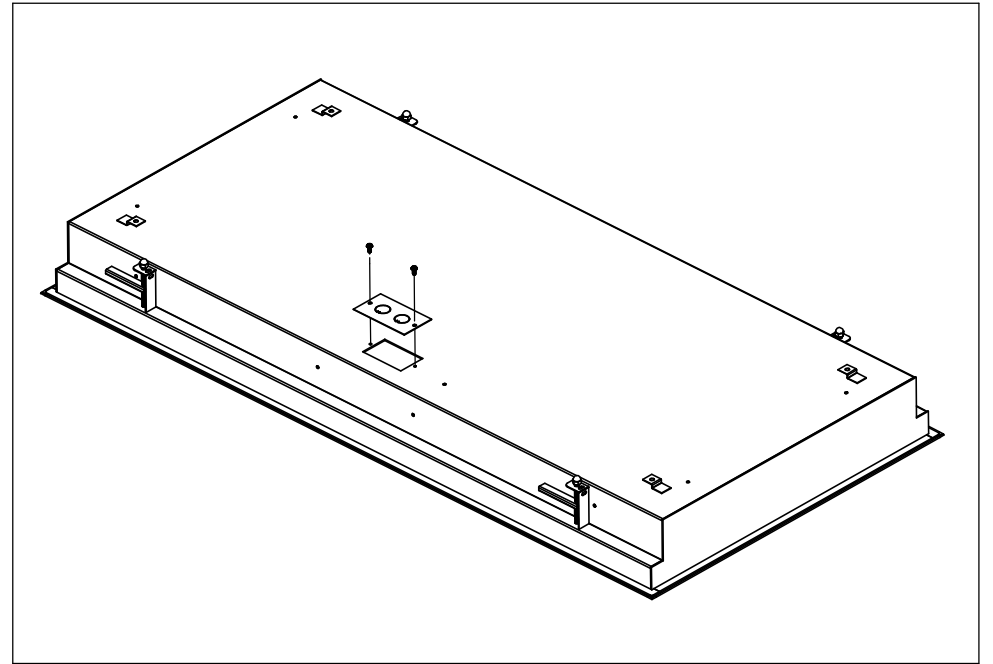

Figure 2

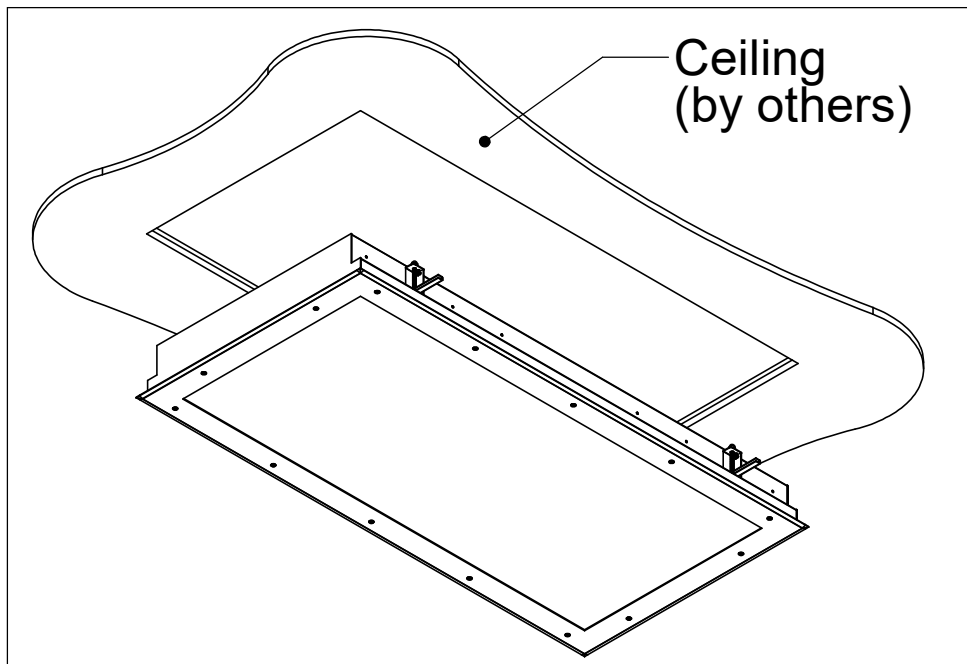

Figure 3

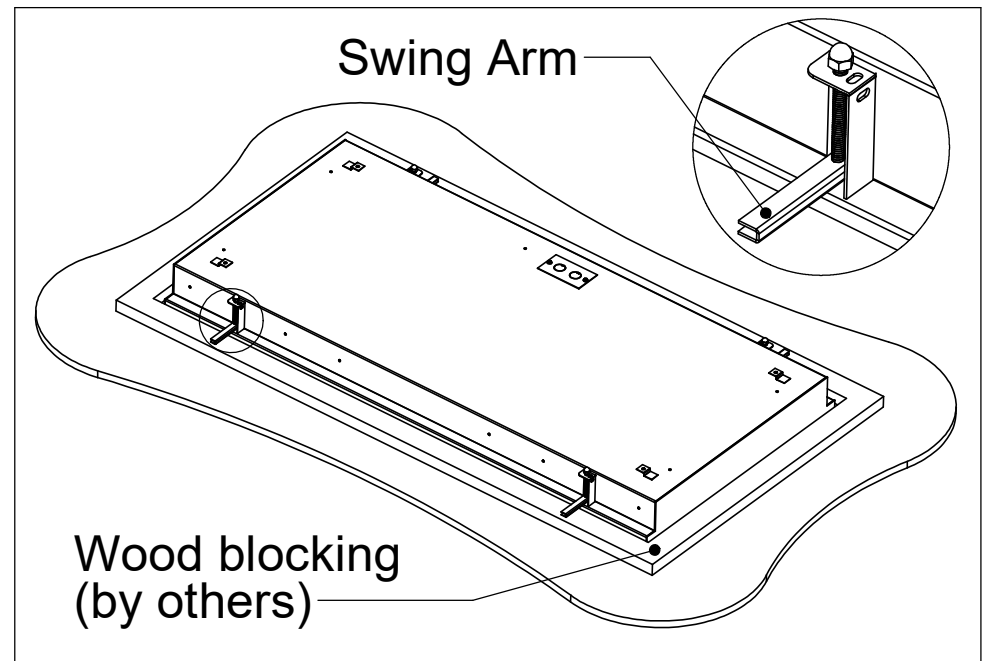

Figure 4

CEILING MOUNT

1. Remove fasteners and Frame (Fig. 1)
2. Remove Access Cover Panel, make all necessary electrical connections and re-attach Access Cover Panel (Fig. 2)
3. Raise Housing into ceiling (Fig. 3)
4. Rotate Swing Arms (Fig. 4)

Installer is responsible for adequately reinforcing walls and/or ceiling to support luminaire weight. These instructions do not claim to cover all details or variations in the equipment, procedure or process. Specifications and dimensions are subject to change.

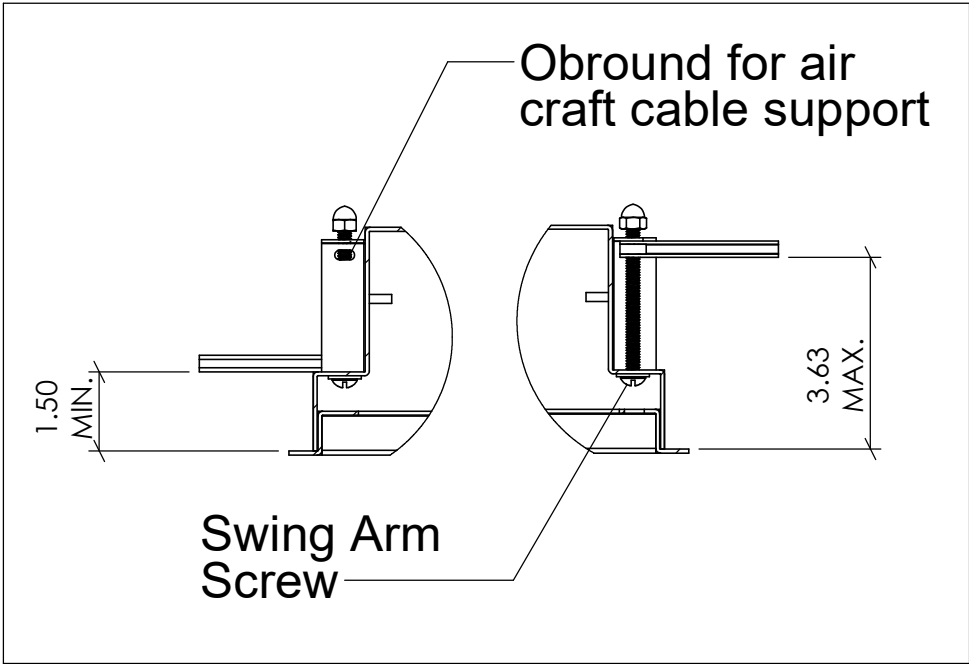

Figure 5

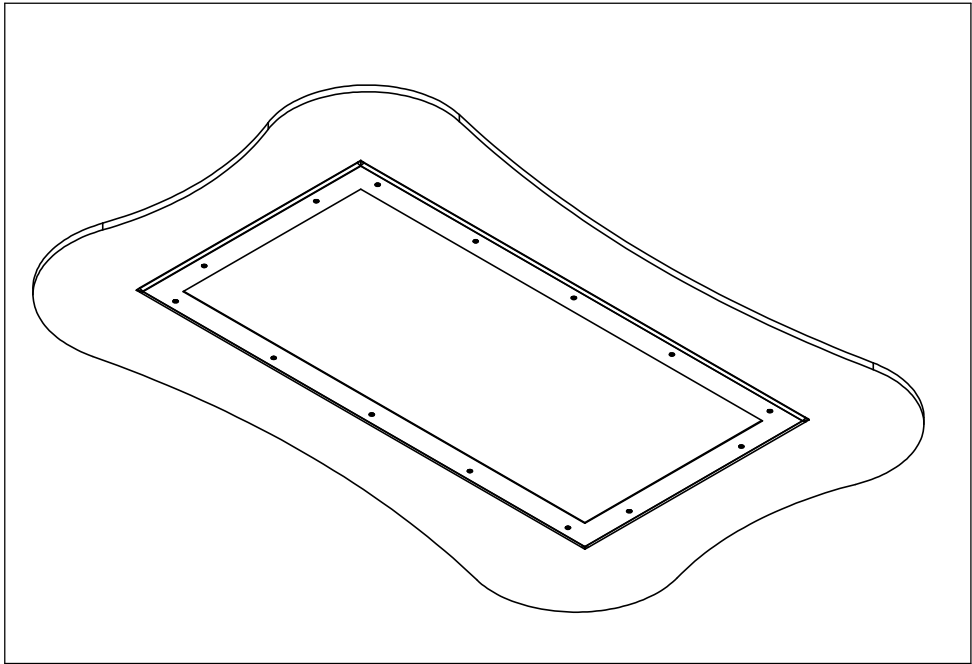

Figure 6

CEILING MOUNT

- 5. Rotate Swing Arm Screws to adjust the height of the Swing Arms as needed (Fig. 5)
- 6. Re-attach Frame (Fig. 6)