

INSTALLATION INSTRUCTIONS

Fixture Family: 33W

Description: Ceiling Mount Fixture

IMPORTANT SAFETY INSTRUCTIONS

- This product must be installed in accordance with the applicable installation code by a person familiar with the construction and operation of the product and the hazards involved.
- Disconnect power before beginning installation.
- Fixture must be installed in compliance with the National Electric Code and any local codes.
- To be installed only by a qualified electrician.
- Proper grounding is required to insure personal safety.
- Read all fixture markings and labels to ensure correct installation of fixture.
- Risk of fire, use minimum of 90C supply connectors.
- These instructions may not cover all details or the variations. If additional information is needed, please contact New Star Lighting.

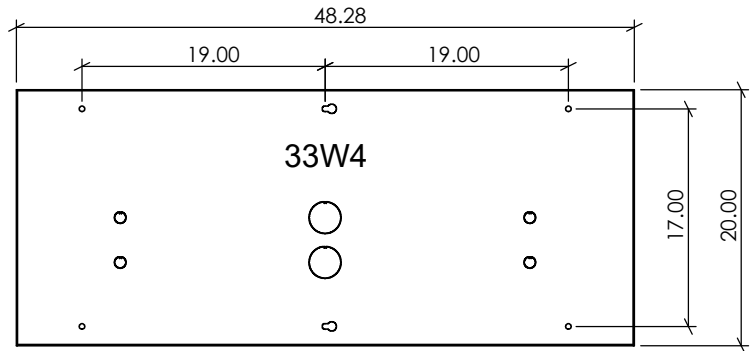
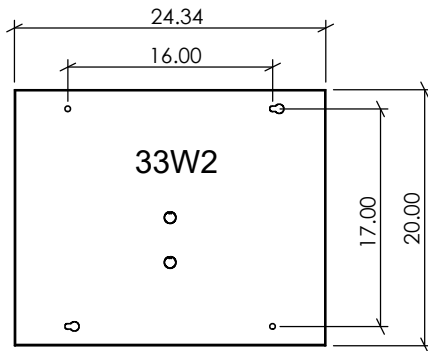

Mounting holes are $\varnothing 0.44"$. Knockouts (K.O.) are $\varnothing 0.88"$ and $\varnothing 2.50"$.

EXPLODED VIEW

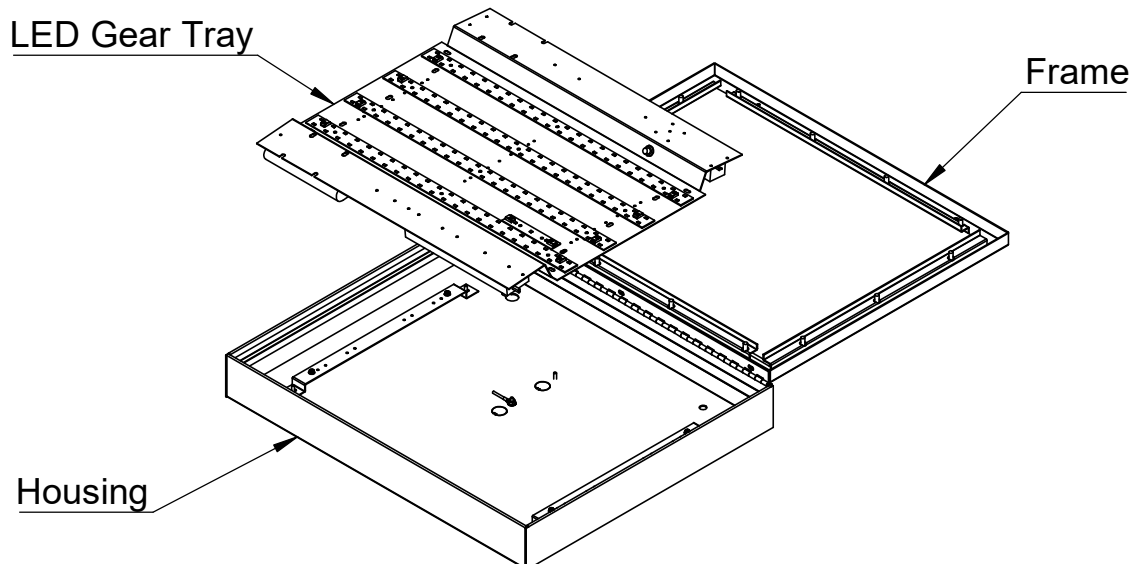

Installer is responsible for adequately reinforcing walls and/or ceiling to support luminaire weight. These instructions do not claim to cover all details or variations in the equipment, procedure or process. Specifications and dimensions are subject to change.

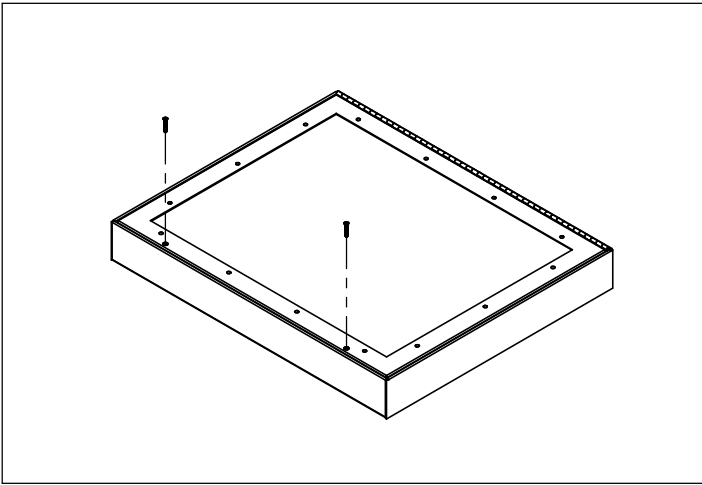

Figure 1

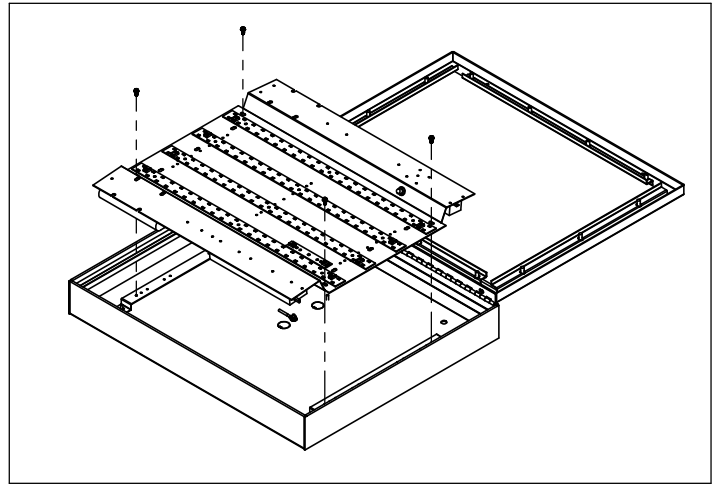

Figure 2

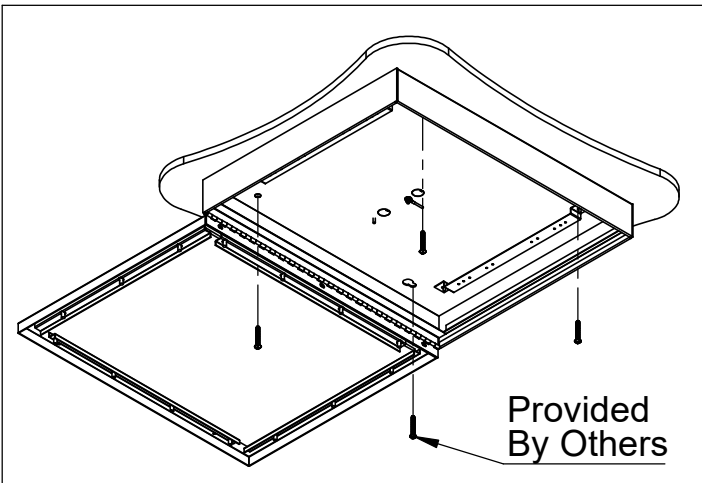

Figure 3

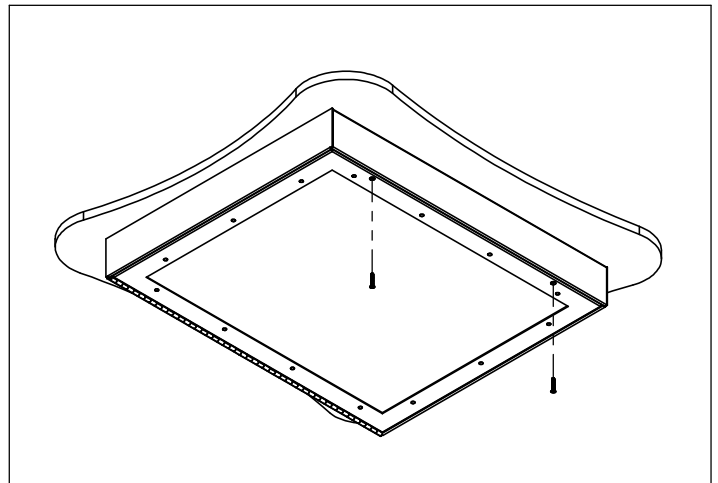

Figure 4

CEILING MOUNT

1. Remove screws from Frame to open fixture (Fig. 1)
2. Remove screws from LED gear tray and remove from fixture. Remove K.O. that best suits installation and make all necessary electrical connections (Fig. 2)
3. Mount in desired location with mounting hardware (provided by others) (Fig. 3)
4. Re-attach LED gear tray to Housing and close fixture (Fig. 4)

Installer is responsible for adequately reinforcing walls and/or ceiling to support luminaire weight. These instructions do not claim to cover all details or variations in the equipment, procedure or process. Specifications and dimensions are subject to change.